

ODEON LIGHT INSTALLATION INSTRUCTION

Item No.:2599/8

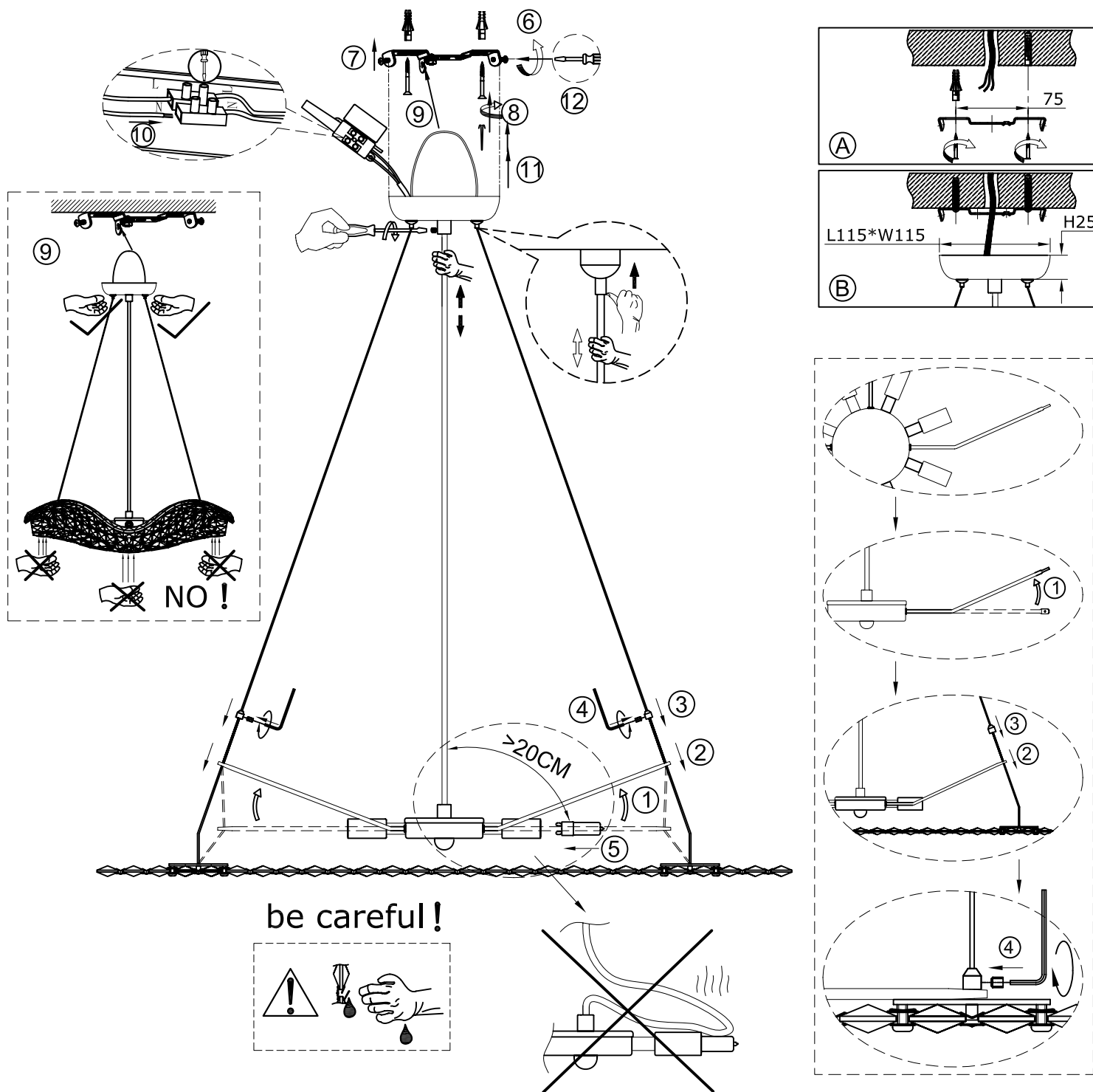

FEATURE

- 220-240V ~ 50Hz
 - Lamp Type: G9 8 X Max.42W
- The lamp can be only indoor used

If in doubt, consult a qualified electrician or contact your retail outlet. Ensure that you always install the fitting to the relevant regulations. Certain regulations indicate that lighting fittings should be installed by a qualified electrician.